

CITY OF CLAREMONT

ZONING PERMIT

Permit No. _____

Date _____

CONTRACTOR'S LICENSE NO. _____		1. DATE _____
2. SITE ADDRESS _____		
3. LEGAL DESCRIPTION PROPERTY I.D. NO. _____ ZONED _____ SECTION _____ LOT _____ BLOCK _____ ADDITION _____ PLAT NUMBER _____ PARCEL NUMBER _____		
4. OWNER (Name) _____ (Address) _____		(Tel. No.) _____
5. Architect (Name) _____ (Address) _____		(Tel. No.) _____
6. Builder (Name) _____ (Address) _____		(Tel. No.) _____
7. TYPE OF WORK Fence <input type="checkbox"/> Deck <input type="checkbox"/> Accessory Structure <input type="checkbox"/> Misc. _____		
8. SIZE OF STRUCTURE (Height) (Width) (Depth)	9. NO. OF STORIES	10. ESTIMATED VALUE
11. COMPLETION DATE	12. PROPERTY DIMENSIONS Width _____ Depth _____	13. NO. OF FAMILIES (If applicable)
14. PROPOSED ELEVATION IN RELATION TO CURB OR WATERWAY. ELEV.	15. PROPERTY AREA OR ACRES Sq. Ft. _____	16. CULVERT SIZE Yes <input type="checkbox"/> No <input type="checkbox"/>
17. FRONT YARD set back from road property _____ Ft.	18. REAR YARD set back _____ Ft.	19. SIDE YARD set back Right Side _____ Left Side _____
SPECIAL CONDITIONS _____ _____ _____		

ACKNOWLEDGEMENT AND SIGNATURE;

The undersigned hereby agrees that, in case such permit is granted, that all work which shall be done and all materials which shall be used shall comply with the plans and specifications herewith submitted and with all the ordinances of said City of Claremont applicable thereto.

SIGNATURE OF APPLICANT

APPROVED BY ZONING ADMINISTRATOR

ZONING APPLICATION SKETCH - CITY OF CLAREMONT

Name _____ Permit No. _____ Date ____ / ____ / ____

ALL SKETCHES MUST BE DRAWN TO SCALE and contain the following information: North Arrow, all abutting streets and alleys with street names, dimensions of lot or lots, all existing buildings on lots, all existing utility lines and easements, proposed buildings, and distances from all property lines to existing or proposed buildings.

Zoning Department Form 002 Page 1 Revised 2/15/01

Crosshatch all existing buildings. **Label** property lines.

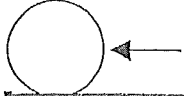

Indicate North in the Circle

SCALE 1/4" = _____

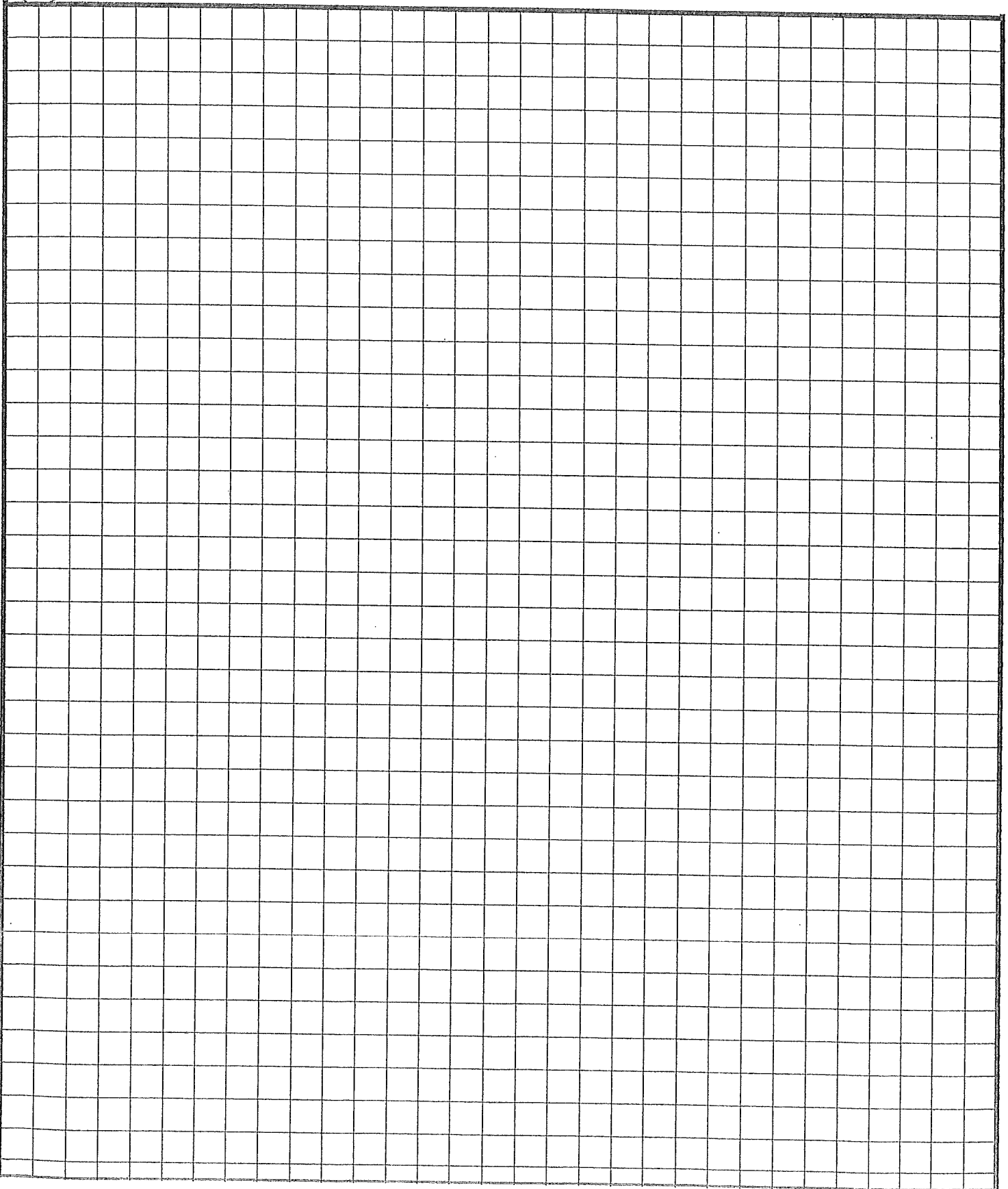

ZONING APPLICATION SKETCH – CITY OF CLAREMONT

Name SAMPLE OF SKETCH DRAWING Permit No. _____ Date / /

ALL SKETCHES MUST BE DRAWN TO SCALE and contain the following information: North Arrow, all abutting streets and alleys with names, dimensions of lot or lots, all existing buildings on lots, all existing utility lines and easements, proposed buildings, and distances from all property lines to existing or proposed buildings.

 Crosshatch all existing buildings. Label property lines.
 ← Indicate North in the Circle.

Zoning Department Form 002 Page 2 Updated 2/15/01

SCALE 1/4" = 5'

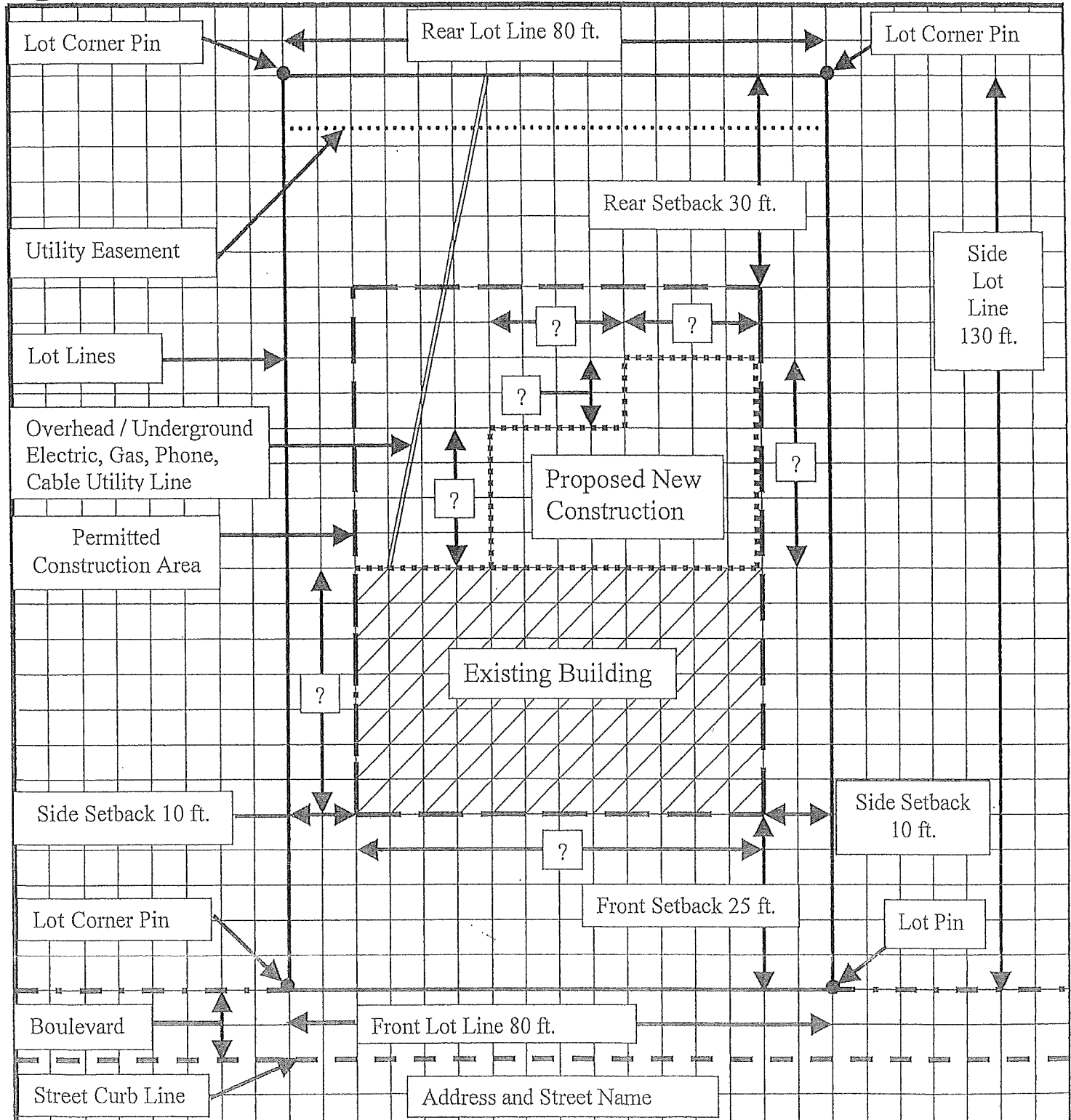

The above sample is for a lot zoned R-1. Lots zoned other than R-1 may have different setback requirements. Remember when making the drawing, use the edge of the roof overhang for the setback requirements not the walls of the proposed construction. Show the location of all utility line connections to the property.